

HIGH - PRESSURE JETTING DUMPGUN1500/3000

with mechanical valve

Z 9-1e
17.08.2022
Page 1/2

HP - Gun with spray tube 750 mm, handle, bypass tube 400 mm and nozzle holder for insert nozzles

without hose connection adapter and nozzle

1500 bar
3000 bar

Part No. 7032747
Part No. 7032535

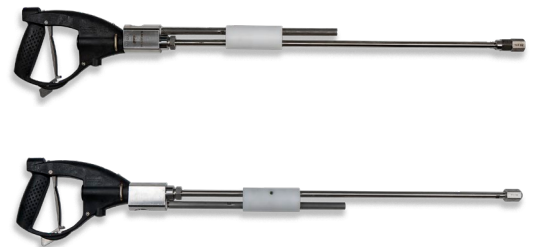

Optional

without spray tube and nozzle holder

1500 bar
3000 bar

Part No. 7032720
Part No. 7032414



Additional equipment

Shoulder support
Initiator for remote control

Part No. 7009215
Part No. 7017928



Technical Data

- Max. working pressure 1500 / 3000 bar (300 MPa)
- Max. capacity 40 l/min / 30 l/min
- Connection M26x1,5 female
- Length total 1000 mm
- Weight approx. 3 - 4 kg complete / approx. 3 kg without spray tube and bypass tube
- Temperature max. 50° C
- Usable nozzle inserts Insert nozzles Form A+B and C (see page Z 41-1e + Z 41-2e) / (up to 1500 bar)
Round jet insert nozzle type 0952 (up to 3000 bar) (see page Z45-1e)
Rotating nozzle PRD3500 LV (see page Z 20-1e)
Nozzle heads DK1 – DK4 for PRD3500 LV (see page Z 20-2e)
Orbital nozzle KOD1500 (see page Z 40-1/2/3/4e) / (up to 1500 bar)
Orbital nozzle KOD2500 (see page Z 40-1/2/3/4e) / (up to 2500 bar)

Applications

For manual surface cleaning of all types of forms and materials with nozzle



For hand-held operation of a spray gun the nozzle diameter must be selected to ensure that the reaction force in the longitudinal axis when used at the max. operating pressure does not exceed 250 N. If the reaction force is in excess of 150 N the gun must be equipped with a support, in compliance with the European Norm EN 1829.

HIGH - PRESSURE JETTING DUMPGUN1500/3000

with mechanical valve

Z 9-1e
17.08.2022
Page 2/2

Accessories and spare parts

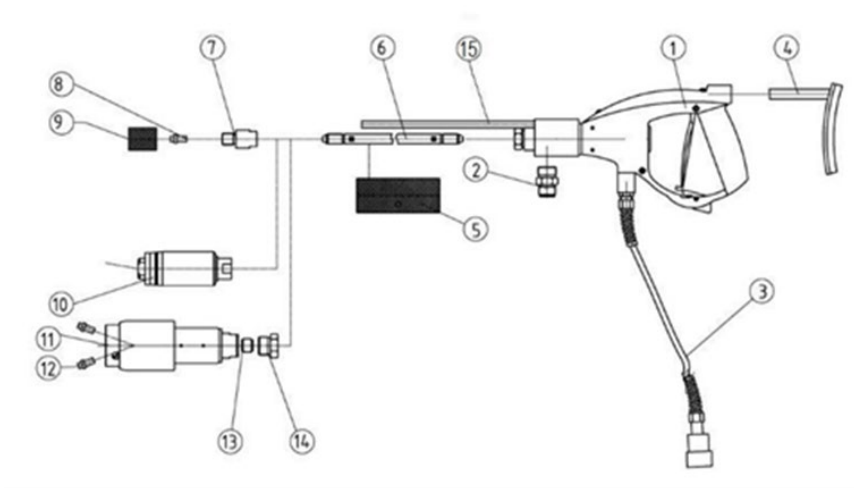

Item	Description	Part No.
1	Gun handle 1500 bar Gun handle 3000 bar	7032720 7032414
2	a. Hose connection adapter M22x1.5 DKO b. Hose connection adapter M24x1.5 DKO c. Pressure ring M14x1.5 LH + Pressure screw M26x1.5	7013332 7009213 7006365 + 7006364
3	Initiator with 2m cable for remote control	7017928
4	Shoulder support	7009215
5	Handle	7011949
6	Gun tube 750 mm 500 mm 1000 mm	7006963 7006964 7006382
7	Adapter for nozzle insert	7009549
8	Insert nozzle	see page Z 41-1e + Z41-2e
9	Cap nut for insert nozzle	1051600
10	Orbital nozzle KOD1500 Orbital nozzle KOD2500	see page Z 40-1/2/3/4e
11	Rotating nozzle PRD3500 LV Nozzle heads DK1 – DK4 for PRD3500 LV Nozzle Ø selection table for DK1 - DK4	see page Z 20-1e see page Z 20-2e see page Z 20-3e – Z 20-6e
12	Straight jet threaded nozzle	see page Z 55-1e
13	Pressure ring M14x1.5 LH	7006365
14	Pressure screw M26x1.5	7006364
15	Bypass pipe	7011945