



P  **C**Chain

Pin Oven Chains: reliable, long-lasting and wear-resistant

NEW
from iwis

Your challenge: safe, reliable conveying of cans and other thin-walled hollow containers at high speed and high temperatures.

Our solution: iwis high-performance Pin Oven Chains are **extremely wear-resistant**. Additional advantage: **specially adapted pins** and **high-quality protective heads** guarantee the right solution for every can application!

Application areas: iwis Pin Oven Chains can be used wherever drinks cans, aerosol cans or other thin-walled containers need to be conveyed, painted, dried etc.



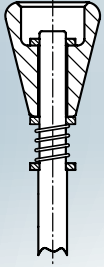

Standard protective head

Highlight

Sliding washer between head and spring

- **Standard:** without sliding washer
- **Optional:** with sliding washer (if required by the relevant application; Only recommended for applications where contamination is uncritical)

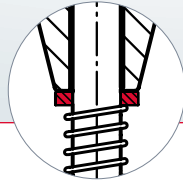

Highlights

- iwis precision roller chains are long-lasting, reliable and particularly wear resistant.
- iwis Pin Oven Chains for can manufacturing applications are initially treated with our special lubricant IPP. IPP is PWIS-free, drip-proof, has a very low evaporation rate, is suitable for high-temperature operation and approved for use in the food industry.
- Standard protective head: high-performance material (PEEK), outstandingly heat-resistant (up to at least 260 °C, depending on application). PEEK is also highly resistant to chemicals.
- Length of transport pins can be adapted to your specifications.
- Transport pins: easy to change on the production line without breaking the chain or removing it from the machine (POChain P/-S)
- Transport pins can be installed at defined intervals (e.g. every 7th pin).
- iwis offers three fixture options for transport pins:
 - POChain-I: pins are integrated in the outer chain plates
 - POChain-S: pins are secured with special nuts
 - POChain-P: split-pin fixture
- Temperature range: 0 °C to +260 °C

Two pin versions to cover all requirements

Bendable

These pins are manufactured to be tough yet bendable enough to withstand inadvertent impact during conveyor jams or accidental contact with the machine frame. These pins are easy to bend back into their original position by hand.

SnapOff

The material specification of these pins cause them to break off in the event of any accidental contact or impact during operation. The advantage for you: the hardness of the transport pin material is similar to that of the pins of the base chain, so the wear rate of both sets of pins is the same.

Our fixture solutions

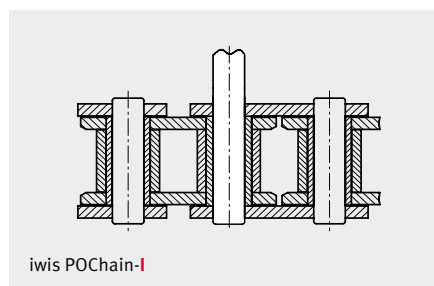

iwis POChain-I

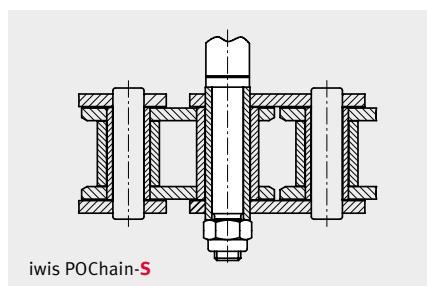

iwis POChain-S

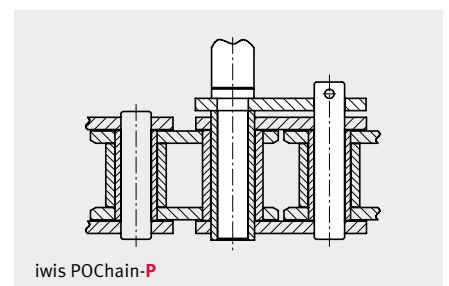

iwis POChain-P



Technical dimensions

Chain type	DIN ISO	iwis designation	Pitch × inner width	Breaking load min.	Roller diameter	Hollow pin inner diameter	Inner width	Pin length	Transport pin diameter	Weight (dependent on transport pin lengths)
			p × b₁ mm	F_b N	d₁ mm	D mm	b₁ mm	b₄ mm	T mm	kg/m
-S	12 A-1/ANSI 60	M 128A SL	3/4 × 1/2"	31,300	11.91	6.0	12.7	26.7	8.00	approx. 2.3
-I	12 A-1/ANSI 60	M 128A SL	3/4 × 1/2"	31,300	11.91	–	12.7	26.3	5.97	approx. 1.9
-P	12 A-1/ANSI 60	M 128A SL	3/4 × 1/2"	31,300	11.91	6.0	12.7	26.7	5.97	approx. 1.9

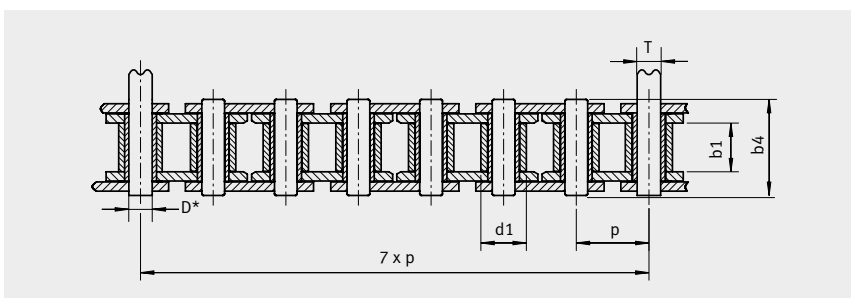

*Notice: dimensions only apply to POChain-P/S

iwis Elastic Can Tip (ECT) **NEW**

Highlights

- Less complex design: one high-temperature elastomeric head replaces one PEEK protective head, three washers and a spring!
- The design and material properties of the elastomeric head take over the damping properties of a spring.
- Defective heads can be replaced easily and without tools.
- Even defective heads still have emergency running capabilities.
- ECT material is PWIS-free and FDA approved!
- Will not damage thin-walled drinks cans.
- Suitable for temperatures up to 215 °C. Available now!

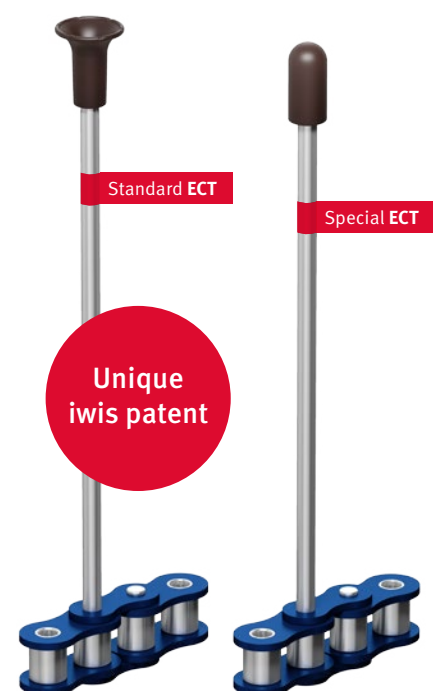

New iwis head solutions
for your special requirements:
innovative and patented

iwis® Spare parts for Pin Oven Chains

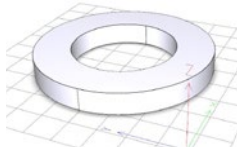

Press-fit washer

Art.-Nr. 40010214

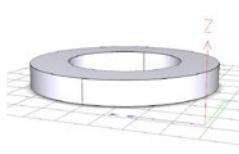

Sliding washer

Art.-Nr. 40010215

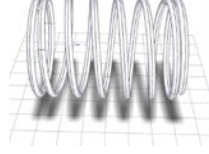

Spring

Art.-Nr. 40010218



Standard protective head

Art.-Nr. 40010217



Protective head ECT

Art.-Nr. 40010169

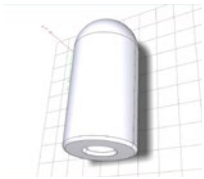

Special ECT

Art.-Nr. 40010119

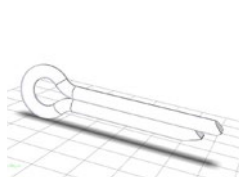

Split pin

Art.-Nr. 40010219



Insertion links

*



3-link sections

*



AGLD link

Art.-Nr. 40010216

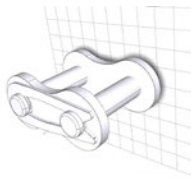

STGLD standard link

Art.-Nr. 40009882



**Installation parts
Version P**

*



**Installation parts
Version S**

*

* Article no. to be determined when ordering

iwis® Tools for Pin Oven Chains

make Pin Oven Chain breaking and riveting easier



**Tool for removal of
standard protective
heads**

Art.-Nr. 40009075



**Tool for fitting
standard protective
heads**

Art.-Nr. 40009903

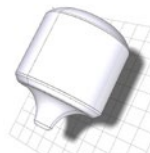

**Tool for fitting ECT
protective head**

Art.-Nr. 40009315

Fully equipped: we also offer a wide range of spare parts and user-friendly tools for fitting and dismantling as a supplement to our iwis Pin Oven Chains.

Our aim: to offer innovative Pin Oven Chain solutions that provide effective support for your production and maintenance processes, thereby saving you time and money.

Sidelight: why lubrication is important

Choosing the right lubricant for your chain is the most decisive factor in ensuring long service life for a chain consists of individual links which behave like swivelling friction bearings.

It is essential to ensure that an adequate film of lubricant always covers the bearings to prevent dry running, which can result in excessive wear.

Inadequate lubrication, in combination with dirt on the chain, can lead to a reduction of transmissible power to as little as 20% of the normal value. In other words, this impairs chain performance more than the sum of all other negative influences.

PWIS, or paint-wetting impairment substances, have a negative impact on paint applied to the outer surface of the beverage can. **Our special test set means that testing for PWIS properties is simplicity itself! Please contact us for more details.**

	Chain velocity v in $\frac{m}{s}$	< 4	4-7	> 7
Lubrication	Excellent	1.0	1.0	1.0
	Poor without contamination	1.4	2.5	10.0
	Poor with contamination	2.5	4.0	
	Nil	5.0	10.0	

1.0 to 1.5 = good / 1.5 to 5.0 = not recommended / from 5.0 = not permitted

Critical points	Test result
Lubricant IPP*	O. K.
PEEK head	O. K.
ECT head	O. K.
MEGAlife bushes*	O. K.
Gloves in production process	O. K.
Chain guides in production process	O. K.
Rubber mat in production process	O. K.

* Supplier certificate available

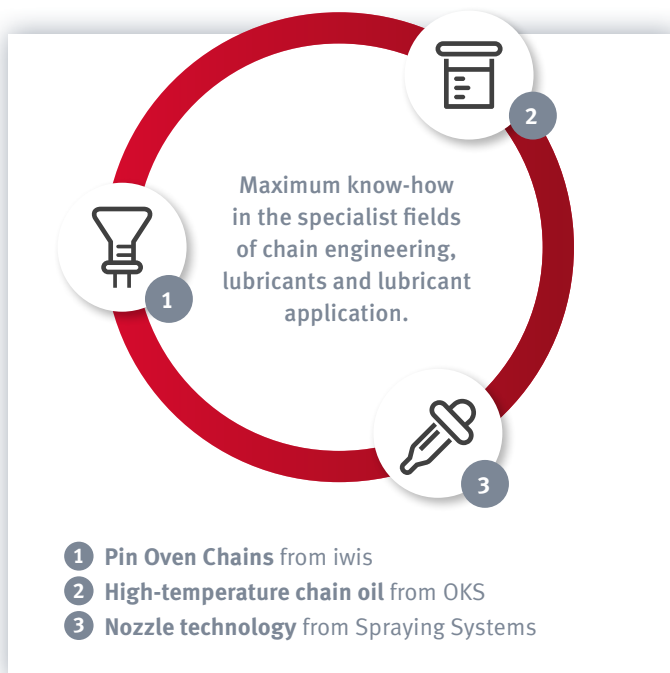

Competence Team Can Making CLA

Functions and benefits

The open cooperation of three reputable companies offers you the best of everything for your chain solution: the combination of ideal chain, optimum lubricant and made-to-measure application. The benefit for you: a significantly longer service life for your chain.

The high-temperature chain oil from OKS and nozzle technology from Spraying Systems Germany are the perfect complement for iwis engineering. You can rely absolutely on the knowledge and experience of these three companies.

Our customers benefit from this collaboration because they are assured of an answer to all their questions related to these three highly complex sub-systems. The combination and concentration of competence not only contributes to the optimisation of our customer's production machinery, but also ensures a longer service life for their chains.

For more information, please see our flyer: **Can Making CLA**



Nomenclature

Our precise nomenclature makes ordering easier for you. The detailed designation code helps you to find and order exactly the right chain for your application quickly and without any trouble – **in writing, by phone** or via our **online request form**.

www.iwis.de/POChain-inquiry

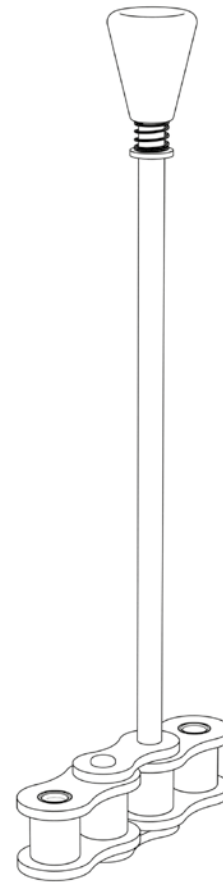
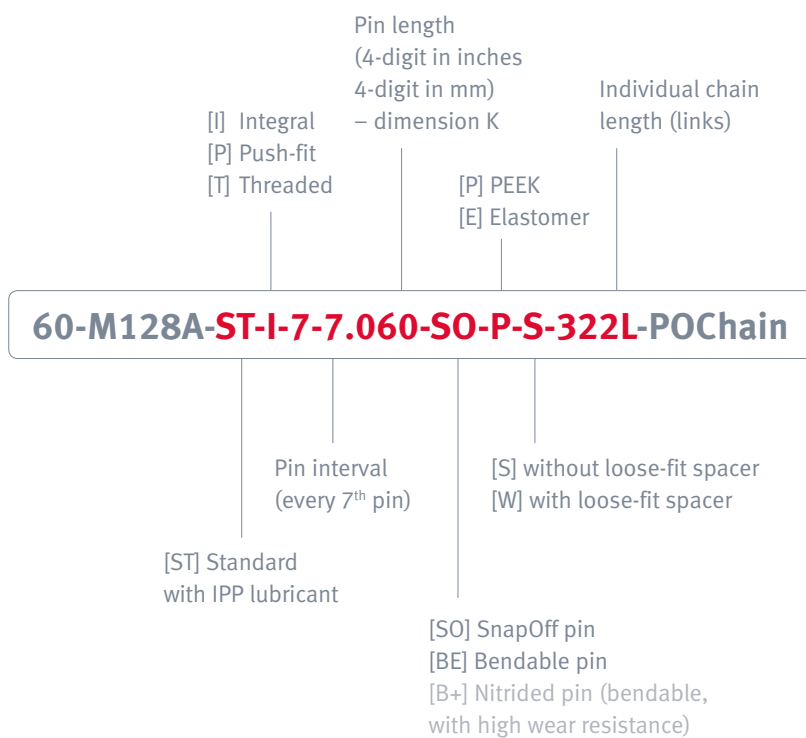

iwis Pin Oven Chain packaging

We always have our customers' interests at heart – not only regarding the quality of our chains, but also where their packaging is concerned. Our packaging protects the chains and guarantees that they will be delivered to you in impeccable condition.

- Robust packaging of chains
- Easy chain handling
- No risk of damaging pins during handling
- iwis patent
- Delivery lengths:
 - 322 links (6.1341 m or 20.125 ft)
 - 392 links (7.4676 m or 24.5 ft)
 - 336 links on request

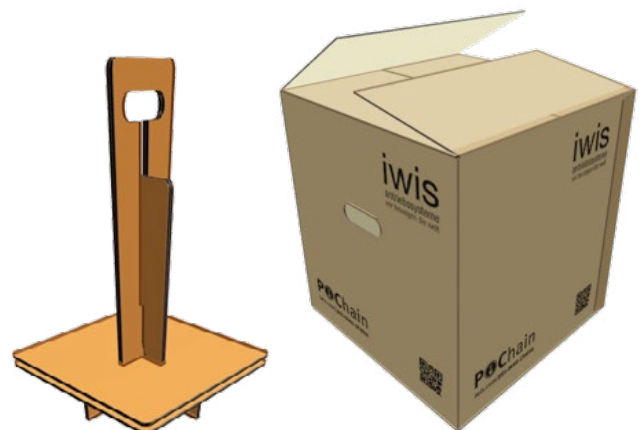



Chain Condition Monitoring

The new iwis chain elongation monitoring system CCM (Chain Condition Monitoring) measures the wear elongation of chains in operation, giving maintenance staff an early indication that the chain is worn and needs to be replaced.

Intelligent chain monitoring

- Enables maintenance staff to (re)act in good time!
- No long downtimes for plant or machinery
- No risk to promised delivery dates – no interruption of the logistics chain
- Prevents financial losses caused by missed production
- Monitoring of precision chain applications
- “Plug ’n’ play” principle applies – no calibration etc. required

- ✓ Simple modular construction
- ✓ Revised design

CCM: a comprehensive solution

- Included in delivery:
 - CCM system including mounting plate
 - Power supply cable
 - USB cable
 - PC software
 - Installation and operating instructions
- 3D data available and can be supplied on request
- Installation kit with standard default setting Depth D = 50 mm (Depth D* depends on chain version and can be varied individually)
- See operating instructions for information on electrical and mechanical connections.



Our subsidiaries

Germany

iwis antriebssysteme GmbH & Co. KG
Albert-Roßhaupter-Straße 53
81369 München
Tel. +49 89 76909-1500
Fax +49 89 76909-1198
sales@iwis.com

Germany

iwis antriebssysteme GmbH
Essener Straße 23
57234 Wilnsdorf
Tel. +49 2739 86-0
Fax +49 2739 86-22
sales-wilnsdorf@iwis.com

Germany

iwis agrisystems
Schützenweg 5
36205 Sontra
Tel. +49 5653 9778-0
Fax +49 5653 9778-26
agrisystems@iwis.com

Great Britain

iwis drive systems Ltd.
Unit 8c Bloomfield Park
Bloomfield Road, Tipton
West Midlands, DY4 9AP
Tel. +44 12 15213600
Fax +44 12 15200822
salesuk@iwis.com

France

iwis systèmes de transmission
10, rue du Luxembourg
69330 Meyzieu
Tel. +33 4374515-70
Fax +33 4374515-71
salesfr@iwis.com

Switzerland

iwis AG Kettentechnik
Bahnweg 4 (Postfach)
5504 Othmarsingen
Tel. +41 62 8898999
Fax +41 62 8898990
info@iwis-ketten.ch

Italy

iwis antriebssysteme Italia
Tel. +39 340 9296142
Fax +49 89 7690949-1726
salesit@iwis.com

China

iwis drive systems (Suzhou) Co., Ltd.
No. 266 LvliangShan Road
215153 Suzhou SND
Tel. +86 512 8566-3020
Fax +86 512 8566-3009
salescn@iwis.com

USA

iwis drive systems, LLC
Building 100, 8266 Zionsville Road
Indianapolis, IN 46268
Tel. +1 317 821-3539
Fax +1 317 821-3569
sales@iwisusa.com

Canada

iwis drive systems, Inc.
101-19097, 26th Avenue,
Surrey BC V3Z 3V7
Tel. +1 604 560-6395
Fax +1 604 560-6397
salesca@iwisusa.com

Brazil

iwis Sistemas de Transmissão
de Energia Mecânica Ltda.
Rua Bento Rosa, nº 1816
Bairro Hidráulica
95.900-000 Lajeado, RS
Tel. +55 51 3748-7402
salesbrazil@iwis.com

South Africa

iwis drive systems, (Pty) Ltd
Unit 3, 127 Koornhof Road
Meadowdale, 1613
Tel. +27 11 392-2306
Fax +27 11 392-3295
salessa@iwis.com

Czechia

iwis antriebssysteme spol. s r.o.
Písecká 893
38601 Strakonice
Tel. +420 383 411811
Fax +420 383 321695
salescz@iwis.com

Turkey

iwis tahrik sistemleri sanayi ve ticaret ltd.şti
Kağıthane Merkez Mah. Bağlar Cad. No: 14
Kağıthane Ofis Park 4C-Blok, TT04-FF2
34406 Kağıthane-İstanbul
Tel. +90-212-939 3843
Fax +90-212 939 3701
salestr@iwis.com

www.iwis.com

Your sales representative

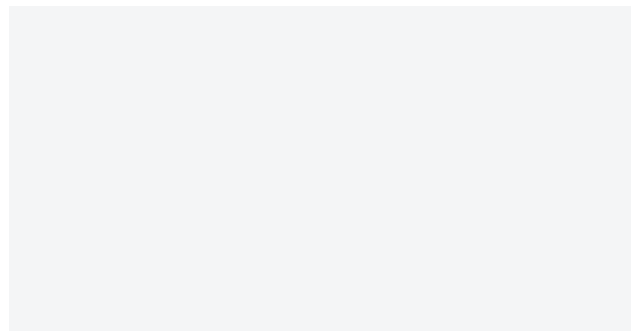

iwis
antriebssysteme
wir bewegen die welt