

ROTARY DAMPERS

TD58 SERIES



FEATURES

- RoHS compliance
- Even as a infinite angle damper a 0.80N·m of maximum torque can be achieved.
- A bi-directional TD58 DAMPER can also be manufactured.

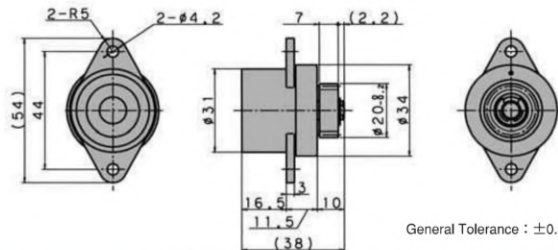

Code	Part No.	Torque [N·m] (Kgf·cm)	Direction	Allowable revolution speed (min ⁻¹)
605806	TD58R1-3K	[0.30] (3.1)	CW (R)	100
605807	TD58L1-3K		CCW (L)	
605804	TD58R1-5K	[0.50] (5.1)	CW (R)	60
605805	TD58L1-5K		CCW (L)	
605801	TD58R1-8K	[0.80] (8.2)	CW (R)	30
605802	TD58L1-8K		CCW (L)	
605830	TD58W1-3K	[0.30] (3.1)	Bi-directional	30

* CW (R) ...Damping effect is available when the gear is rotated in CW. (Cap color: Dark grey)
 CCW (L) ...Damping effect is available when the gear is rotated in CCW. (Cap color: Grey)

Gear Specification	
Profile of Gear	Standard Spur Gear
Tooth Profile	Full Depth Tooth
Module	1
Pressure Angle	20°
Number of Teeth	18
P.C.D. [mm]	φ18
Displacement over given Number of Teeth [mm]	7.63/3

DURABILITY

The torque is measured by a TOK made device at 30min⁻¹ (30rpm)

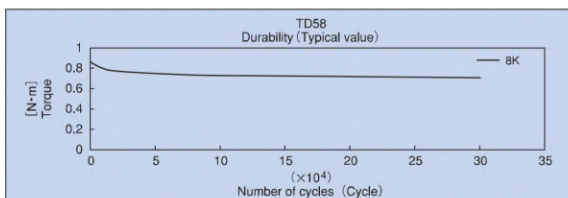

Durability	200,000cycles	
Part No.	Initial torque [N·m] (Kgf·cm)	(min ⁻¹) Revolution speed
TD58R1/L1-3K	[0.24~0.36] (2.35~3.53)	30
TD58R1/L1-5K	[0.40~0.60] (3.92~5.88)	
TD58R1/L1-8K	[0.64~0.96] (6.27~9.41)	
TD58W1-3K	[0.24~0.36] (2.35~3.53)	

SPEED REVOLUTION CHARACTERISTICS

Measurements of torque are taken after each revolution per minute using the TOK-made device for measuring Torque.

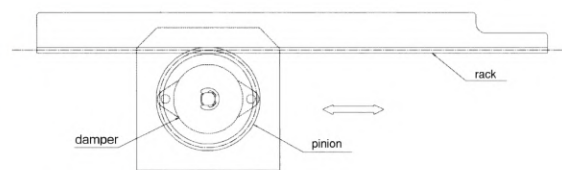
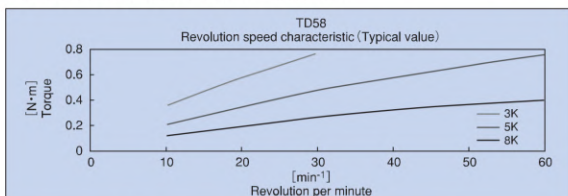

TEMPERATURE CHARACTERISTICS

After the damper is stabilized at room temperature for 1 hour or more, the torque at 30min⁻¹ (30rpm) is measured using a TOK made device.

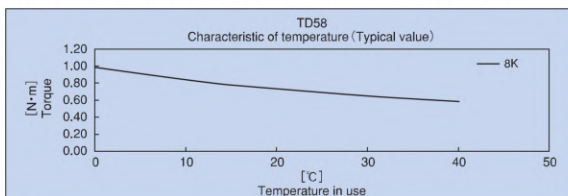

TEST CONDITION

- ① Test method : Gear test by rack and pinion
- ② Number of cycle : 200,000cycles
- ③ Length of rack : ℓ=180mm
- ④ Moving speed : 75mm/sec
- ⑤ Revolution per minute : 30min⁻¹
- ⑥ Pinion : P.C.D=φ48mm
Module=1.5
Number of teeth=32
- ⑦ Radial force : 13.4N(1.37kgf·cm)
- ⑧ Torque after the test : 0.5N·m or more (30min⁻¹)
- ⑨ Number of revolution per cycle : approx 1.2 rev.(one-way)

TOK, Inc.

HEAD OFFICE, TOKYO, JAPAN – TEL : 81-3-3969-1534 FAX : 81-3-3969-9354
 EMAIL : en-contact@tok-inc.com

Product specification are subject to change without prior notice.

Before assembly or use of any bearing, please read "Caution for Use"