

Mechanical Power Clamping Nut I Series MDR

Series MDR // side operation // low profile // with through-hole thread

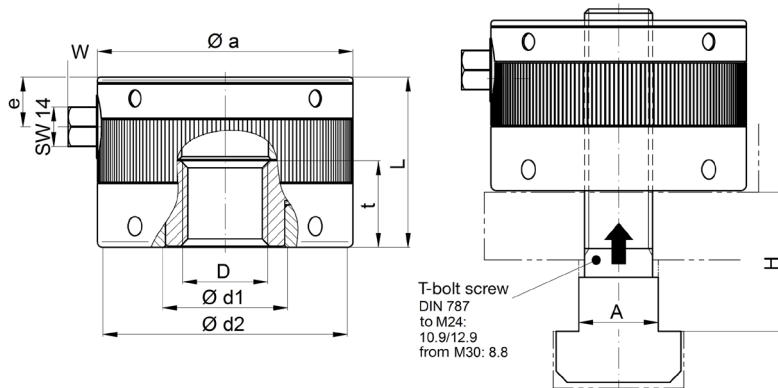

Technical data and dimensions [mm]: length dimensions according to DIN ISO 2768 mH

MDR Size	nominal clamping force [kN]	thread D* (7G)	max. actuation torque [Nm]	T-Nut A	max. static load [kN]	weight approx. [kg]	Øa	Ød1	Ød2	e	L	t
120	120	M 16	65	18	130	2,2	90	44	86	17,5	60	30
		M 20	90	22	200							
		M 24	95	28	240							
		M 30	105	36	240							
150	150	M 24	90	28	300	4,2	120	52	115	17,5	65	35
		M 30	100	36	300	4,1						
		M 36	110	42	300	4,0						
		M 42	125	48	300	3,9						

*property class of threaded bolt up to M24 min. Q 10.9; from M30 Q 8.8 (further thread sizes i.e. inches on request)
 standard thread tolerance „7G“
 max. allowed temperature range: -30°C up to +200°C



ordering example: Clamping nut MDR 150 - M 36
 Incl. T-slot screw MDR 120 - M 30 - 100 - 36

series and size _____
 thread size (T-slot screw thread according to DIN 787) _____
 clamping height (H=100) _____
 groove width (A=36 mm) _____