

Kabelverschraubungen / Cable Glands

we **ge**® K Standard



Material	PA 6
Farbe	lichtgrau (RAL 7035)
Dichtring	CR
O-Ring	NBR-Oz
Schutzklasse	IP66/ IP68 - 5 bar
Prüfnorm*	UL 514B
Zugentlastung	DIN EN 62444 Tab. 2A
Temperaturbereich	-25 °C bis +100 °C

material	PA 6
colour	light grey (RAL 7035)
sealing ring	CR
o-ring	NBR-Oz
protection class	IP66/ IP68 - 5 bar
test standard*	UL 514B
strain relief	DIN EN 62444 Tab. 2A
range of temperature	-25 °C to +100 °C

Gewinde thread			H	L		Bestell-Nr. ref.-number
-------------------	--	--	---	---	--	----------------------------

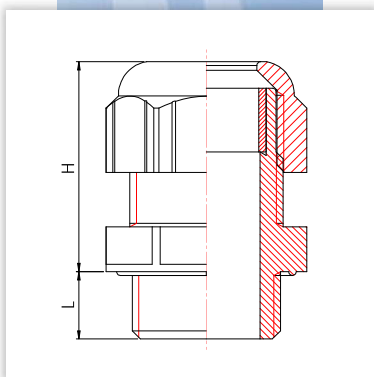

kurzes Anschlussgewinde / short connection thread

M 12 x 1,5*	2	-	6,5	15	20	8	100	342.1200.0
M 16 x 1,5*	2	-	7	20	22	8	100	342.1601.0
M 16 x 1,5*	4	-	10	20	22	8	100	342.1600.0
M 20 x 1,5*	4	-	10	24	28	9	100	342.2001.0
M 20 x 1,5*	6	-	12	24	28	9	100	342.2000.0
M 20 x 1,5*	7	-	14	27	28	9	100	342.2002.0
M 25 x 1,5*	5	-	14	28	32	11	50	342.2501.0
M 25 x 1,5*	9	-	16	28	32	11	50	342.2500.0
M 32 x 1,5	11	-	21	36	38	11	25	342.3200.0
M 40 x 1,5	16	-	28	46	43	11	10	342.4000.0
M 50 x 1,5	27	-	34,5	55	49	13	5	342.5000.0
M 63 x 1,5	30	-	44,5	65	53	17	5	342.6300.0



Pg 7	3,5	-	6,5	15	21	8	50	341.0700.0
Pg 9	4	-	8	19	23	8	50	341.0900.0
Pg 11	5	-	10	22	29	8	50	341.1100.0
Pg 13,5	6	-	12	24	28	9	50	341.1300.0
Pg 16	10	-	14	27	32	10	50	341.1600.0
Pg 21	13	-	18	33	33	11	25	341.2100.0
Pg 29	18	-	25	42	40	11	25	341.2900.0
Pg 36	22	-	34	53	50	13	10	341.3600.0
Pg 42	30	-	38	60	52	13	5	341.4200.0
Pg 48	32	-	44	65	53	14	5	341.4800.0

langes Anschlussgewinde / long connection thread

M 12 x 1,5*	2	-	6,5	15	20	12	100	343.1200.0
M 16 x 1,5*	4	-	10	20	22	12	100	343.1600.0
M 20 x 1,5*	6	-	12	24	28	15	100	343.2000.0
M 25 x 1,5*	9	-	16	28	32	15	50	343.2500.0
M 32 x 1,5	11	-	21	36	38	15	25	343.3200.0

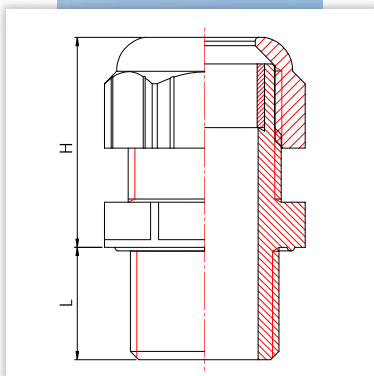

*ohne O-Ring / without o-ring

*Details zu den Prüfungen finden Sie im technischen Anhang ab Seite 106/107
Details of the tests can be found in the technical appendix from page 106/107

Kabelverschraubungen / Cable Glands

wege® K Standard

Material	PA 6	material	PA 6
Farbe	silbergrau (RAL 7001)	colour	silver grey (RAL 7001)
Dichtring	CR	sealing ring	CR
Schutzklasse	IP66/ IP68 - 5 bar	protection class	IP66/ IP68 - 5 bar
Prüfnorm*	UL 514B	test standard*	UL 514B
Zugentlastung	DIN EN 62444 Tab. 2A	strain relief	DIN EN 62444 Tab. 2A
Temperaturbereich	-25 °C bis +100 °C	range of temperature	-25 °C to +100 °C

Gewinde thread			H	L		Bestell-Nr. ref.-number
-------------------	--	--	---	---	--	----------------------------

kurzes Anschlussgewinde / short connection thread								
M 12 x 1,5*	2	-	6,5	15	20	8	100	342.1200.1
M 16 x 1,5*	2	-	7	20	22	8	100	342.1601.1
M 16 x 1,5*	4	-	10	20	22	8	100	342.1600.1
M 20 x 1,5*	4	-	10	24	28	9	100	342.2001.1
M 20 x 1,5*	6	-	12	24	28	9	100	342.2000.1
M 20 x 1,5*	7	-	14	27	28	9	100	342.2002.1
M 25 x 1,5*	5	-	14	28	32	11	50	342.2501.1
M 25 x 1,5*	9	-	16	28	32	11	50	342.2500.1
M 32 x 1,5	11	-	21	36	38	11	25	342.3200.1
M 40 x 1,5	16	-	28	46	43	11	10	342.4000.1
M 50 x 1,5	27	-	34,5	55	49	13	5	342.5000.1
M 63 x 1,5	30	-	44,5	65	53	17	5	342.6300.1

Pg 7	3,5	-	6,5	15	21	8	50	341.0700.1
Pg 9	4	-	8	19	23	8	50	341.0900.1
Pg 11	5	-	10	22	29	8	50	341.1100.1
Pg 13,5	6	-	12	24	28	9	50	341.1300.1
Pg 16	10	-	14	27	32	10	50	341.1600.1
Pg 21	13	-	18	33	33	11	25	341.2100.1
Pg 29	18	-	25	42	40	11	25	341.2900.1
Pg 36	22	-	34	53	50	13	10	341.3600.1
Pg 42	30	-	38	60	52	13	5	341.4200.1
Pg 48	32	-	44	65	53	14	5	341.4800.1

langes Anschlussgewinde / long connection thread								
M 12 x 1,5*	2	-	6,5	15	20	12	100	343.1200.1
M 16 x 1,5*	4	-	10	20	22	12	100	343.1600.1
M 20 x 1,5*	6	-	12	24	28	15	100	343.2000.1
M 25 x 1,5*	9	-	16	28	32	15	50	343.2500.1
M 32 x 1,5	11	-	21	36	38	15	25	343.3200.1

*ohne O-Ring / without o-ring

*Details zu den Prüfungen finden Sie im technischen Anhang ab Seite 106/107
Details of the tests can be found in the technical appendix from page 106/107

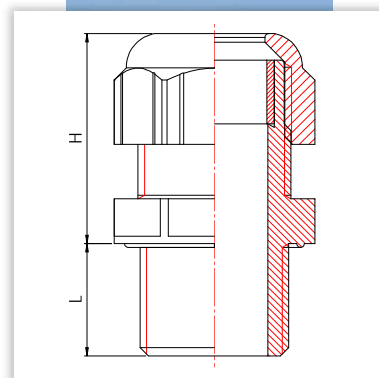
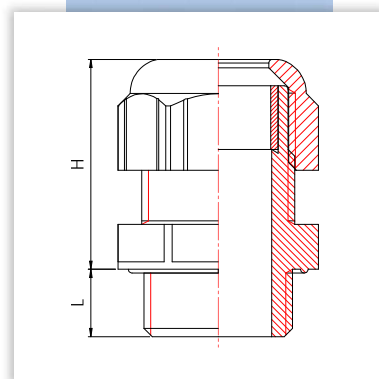

Kabelverschraubungen / Cable Glands

wege® K Standard

Material	PA 6
Farbe	tiefschwarz (RAL 9005)
Dichtring	CR
Schutzklasse	IP66/ IP68 - 5 bar
Prüfnorm*	UL 514B
Zugentlastung	DIN EN 62444 Tab. 2A
Temperaturbereich	-25 °C bis +100 °C

material	PA 6
colour	jet black (RAL 9005)
sealing ring	CR
protection class	IP66/ IP68 - 5 bar
test standard*	UL 514B
strain relief	DIN EN 62444 Tab. 2A
range of temperature	-25 °C to +100 °C

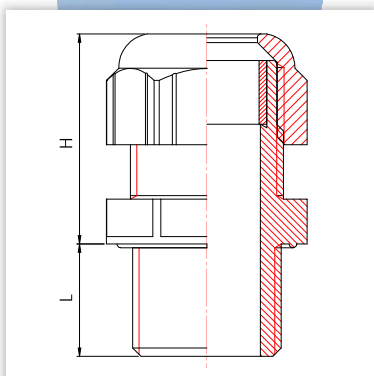
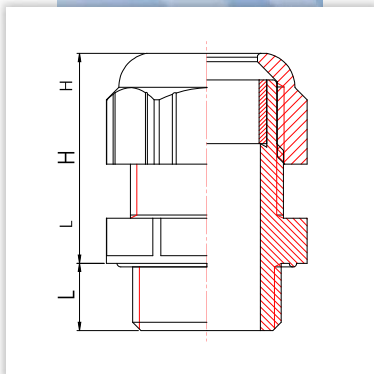

Gewinde thread			H	L		Bestell-Nr. ref.-number
-------------------	--	--	---	---	--	----------------------------

kurzes Anschlussgewinde / short connection thread								
M 12 x 1,5*	2	-	6,5	15	20	8	100	342.1200.3
M 16 x 1,5*	2	-	7	20	22	8	100	342.1601.3
M 16 x 1,5*	4	-	10	20	22	8	100	342.1600.3
M 20 x 1,5*	4	-	10	24	28	9	100	342.2001.3
M 20 x 1,5*	6	-	12	24	28	9	100	342.2000.3
M 20 x 1,5*	7	-	14	27	28	9	100	342.2002.3
M 25 x 1,5*	5	-	14	28	32	11	50	342.2501.3
M 25 x 1,5*	9	-	16	28	32	11	50	342.2500.3
M 32 x 1,5	11	-	21	36	38	11	25	342.3200.3
M 40 x 1,5	16	-	28	46	43	11	10	342.4000.3
M 50 x 1,5	27	-	34,5	55	49	13	5	342.5000.3
M 63 x 1,5	30	-	44,5	65	53	17	5	342.6300.3

Pg 7	3,5	-	6,5	15	21	8	50	341.0700.3
Pg 9	4	-	8	19	23	8	50	341.0900.3
Pg 11	5	-	10	22	29	8	50	341.1100.3
Pg 13,5	6	-	12	24	28	9	50	341.1300.3
Pg 16	10	-	14	27	32	10	50	341.1600.3
Pg 21	13	-	18	33	33	11	25	341.2100.3
Pg 29	18	-	25	42	40	11	25	341.2900.3
Pg 36	22	-	34	53	50	13	10	341.3600.3
Pg 42	30	-	38	60	52	13	5	341.4200.3
Pg 48	32	-	44	65	53	14	5	341.4800.3

langes Anschlussgewinde / long connection thread								
M 12 x 1,5*	2	-	6,5	15	20	12	100	343.1200.3
M 16 x 1,5*	4	-	10	20	22	12	100	343.1600.3
M 20 x 1,5*	6	-	12	24	28	15	100	343.2000.3
M 25 x 1,5*	9	-	16	28	32	15	50	343.2500.3
M 32 x 1,5	11	-	21	36	38	15	25	343.3200.3

*ohne O-Ring / without o-ring

*Details zu den Prüfungen finden Sie im technischen Anhang ab Seite 106/107
Details of the tests can be found in the technical appendix from page 106/107