

## TD88 SERIES

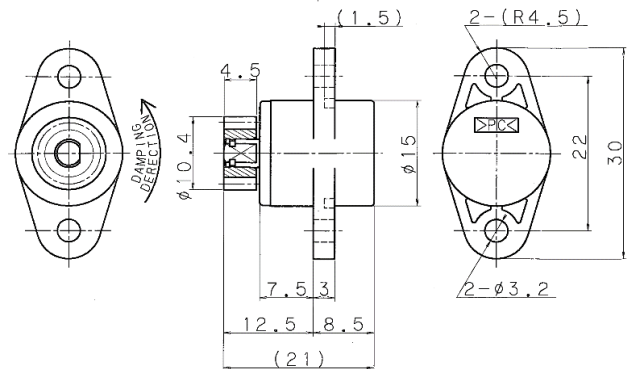

- FEATURES**
- RoHS compliance
  - High durability : 200,000 times
  - Compact size



Code	Part No.	Torque [mN·m] (gf·cm)		Direction
608860	TD88R1-100	[10]	(102)	CW(R)
608870	TD88L1-100	[10]	(102)	CCW(L)
608840	TD88R1-200	[20]	(204)	CW(R)
608850	TD88L1-200	[20]	(204)	CCW(L)
608820	TD88R1-300	[30]	(310)	CW(R)
608830	TD88L1-300	[30]	(310)	CCW(L)
608800	TD88R1-400	[40]	(408)	CW(R)
608810	TD88L1-400	[40]	(408)	CCW(L)

\*The bi-directional type can also be provided.

\*Non-gear type can also be provided.

\*Available in the different torque.

### DURABILITY

The torque is measured by a TOK made device at 30min-1 (30rpm)

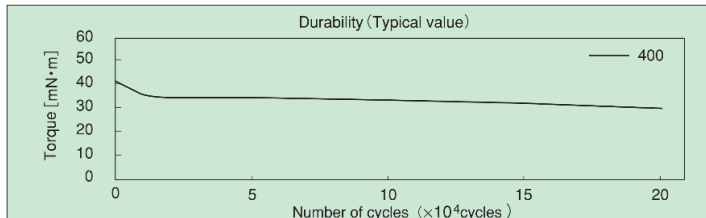

### SPEED REVOLUTION CHARACTERISTICS

Measurements of torque are taken after each revolution per minute using the TOK-made device for measuring Torque.

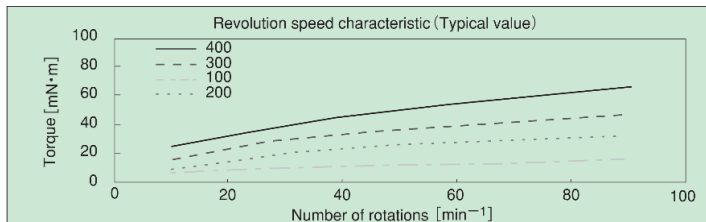

### TEMPERATURE CHARACTERISTICS

After the damper is stabilized at room temperature for 1 hour or more, the torque at 30min-1 (30rpm) is measured using a TOK made device.

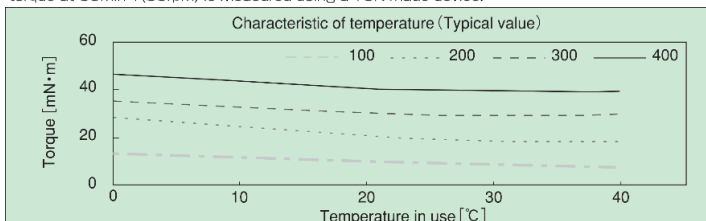

Gear Specification	
Profile of Gear	Standard Spur Gear
Tooth Profile	Full Depth Tooth
Module	0.8
Pressure Angle	20°
Number of Teeth	11
P.C.D [mm]	Φ8.8
Displacement over given Number of Teeth [mm]	3.67/2

<Standard Components>	
Part name	Material
Housing	PC
Shaft	SUS
Cap	PC
Gear	POM

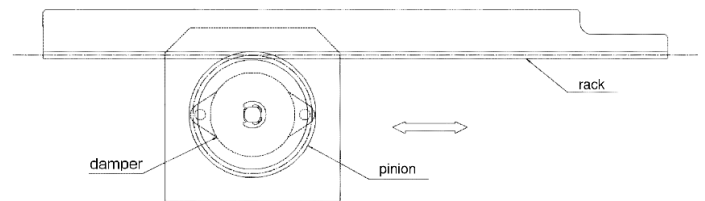

### TEST CONDITION

- ①Test method : Gear test by rack and pinion
- ②Number of cycle : 200,000cycles
- ③Length of rack :  $l=30\text{mm}$
- ④Moving speed : 14mm/sec
- ⑤Revolution per minute : 30min<sup>-1</sup>
- ⑥Pinion : Same as the above gear specification
- ⑦Torque after the test : 20mN·m or more (30min<sup>-1</sup>)
- ⑧Number of revolution per cycle : approx 1 rev.(one-way)

**TOK, Inc.**

HEAD OFFICE, TOKYO, JAPAN  
TEL:81-3-3969-1584 EMAIL:en-contact@tok-inc.com

Product specification are subject to change without prior notice.

CAD Data Download

<https://bit.ly/3bKVKOc>

