

CBG FirePan 50/90

TDS No. 7200

Fire-resistant composite sandwich core panel on basalt and ceramic basis for the production of fire-resistant constructions in the sphere of building construction and container construction, as well as comparable application

- ✓ 100% of natural origin, chemically neutral
- ✓ antibacterial
- ✓ corrosion resistant
- ✓ heat resistant
- ✓ water repellent
- ✓ vibration damping
- ✓ non-flammable
- ✓ no smouldering
- ✓ recyclable

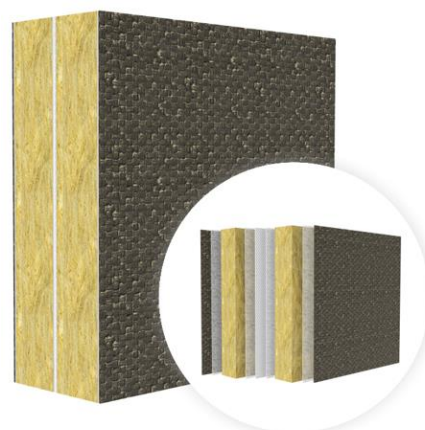

Properties	Data
Description	Composite-Sandwich-Core-Panel
Application area	e.g. production of refractory building structures
Weight per unit area, [kg/m ²]	14 ± 10% with moisture content – max. 4 %
Gross thickness, [mm]	50 ± 1
Material	ceramic basalt fiber and grid laminate, specific mineral wool (basalt fibers), inorganic fire protection adhesive Ceramatrix 01-50
Density [kg/m ³]	280 ± 10%
Compressive strength according to EN 826 [kPa]:	100 ± 10
Tensile strength according to EN 1607 [kPa]	30 ± 5
Classification according to DIN EN-13501-2	F-90
Inorganic content [%]:	approx. 99
Connections within the construction	e.g. tongue and groove, mounting rails, screws and other mounting materials
Surface *:	Ceramic basalt fibre laminates (option: coated with CPL decorative layer in various colours, flame retardant according to DIN EN)
Useful width*:	up to 1200 ± 1 mm
Length *:	up to 3050 ± 2 mm

Delivery

* - Various sizes and surfaces are possible on request

- ✓ Delivery on pallets wrapped with stretch film
- ✓ incl. connecting strip



Processing and storage

- ✓ The panel is ready for installation and requires no further processing
- ✓ Excellent mechanical properties of the panel allow to use screw and dowel-screw fasteners, both on flat and angle connections
- ✓ Workable with ordinary cutting/grinding tool
- ✓ The usual protective measures must be taken during processing. Gloves, respiratory protection and safety glasses are recommended. Please note the instructions for use "Handling mineral wool and insulation materials (glass wool, rock wool)" from BG Bau.
- ✓ Horizontal storage, e.g. on pallets, on a level surface, secure against slipping



Subject to modifications

📍 CBG Composites GmbH Egerpohl 2 D-51688 Wipperfuert / Germany

☎ Tel: 02267-67-0 Fax: 02267-67-222

🌐 www.cbg-composites.de

✉ info@cbg-composites.de