

TLEU SERIES

RoHS



FEATURES

- Magnet hysteresis coupling
- Various torque selection
- Compact and lightweight
- High durability
- Stable torque

APPLICATION EXAMPLES

- Copy machines
- ATM

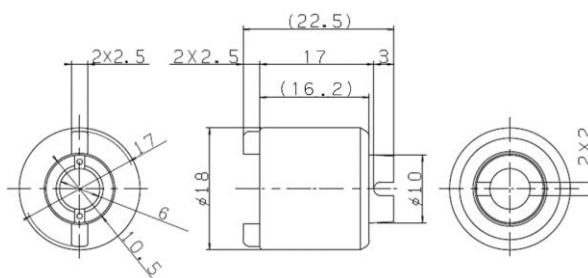

Code	Part No.	Torque [mN·m] (gf·cm)	Allowable Revolution Speed [r.p.m]	Application Shaft [mm]	Rotation Direction
560000	TLEU1-618-5W	5 (51)	2000	φ 6	Both Direction
560010	TLEU1-618-10W	10 (102)			
560020	TLEU1-618-15W	15 (153)			
560030	TLEU1-618-20W	20 (204)			
560040	TLEU1-618-25W	25 (255)			
560050	TLEU1-618-30W	30 (306)			
560060	TLEU1-618-35W	35 (357)			
560070	TLEU1-618-40W	40 (408)			
560080	TLEU1-618-45W	45 (459)			

DURABILITY

Test with 2000min⁻¹ (2000rpm) and measure with 500min⁻¹ (500rpm)

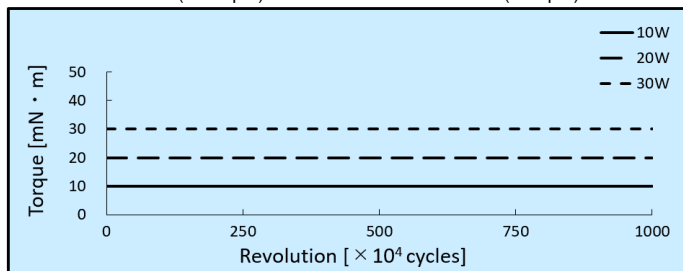

MAIN MATERIALS

Part name	Material
Housing	Aluminium
Sleeve	Plastic
Bush	Sintered Brass
Magnet	NdFeB·FCC

SPEED CHARACTERISTICS

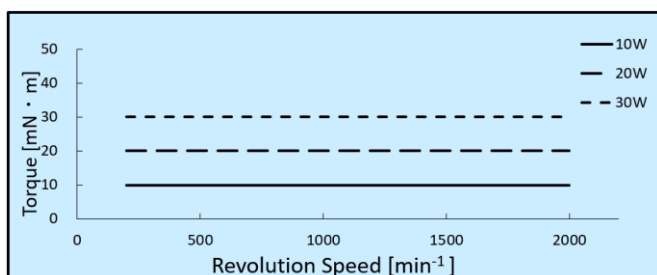

TEMPERATURE CHARACTERISTICS

The torque is measured at 500min⁻¹ (500rpm)

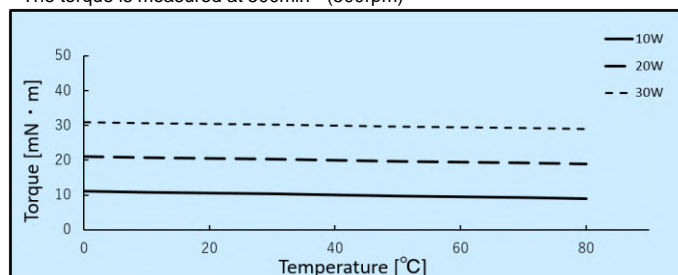

MOUNTING IMAGE

