

# Kabelverschraubungen / Cable Glands

we **ge**® M Standard UD



|                          |                     |
|--------------------------|---------------------|
| <b>Material</b>          | Messing vernickelt  |
| <b>Dichteinsatz</b>      | TPE                 |
| <b>O-Ring</b>            | NBR-Oz              |
| <b>Schutzklasse</b>      | IP66/ IP68 - 5 bar  |
| <b>Zugentlastung</b>     | DIN EN62444 Tab. 2A |
| <b>Temperaturbereich</b> | -40 °C bis +100 °C  |

|                             |                     |
|-----------------------------|---------------------|
| <b>material</b>             | brass nickel-plated |
| <b>sealing insert</b>       | TPE                 |
| <b>o-ring</b>               | NBR-Oz              |
| <b>protection class</b>     | IP66/ IP68 - 5 bar  |
| <b>strain relief</b>        | DIN EN62444 Tab. 2A |
| <b>range of temperature</b> | -40 °C to +100 °C   |

|                   |  |  |   |   |  |                            |
|-------------------|--|--|---|---|--|----------------------------|
| Gewinde<br>thread |  |  | H | L |  | Bestell-Nr.<br>ref.-number |
|-------------------|--|--|---|---|--|----------------------------|

## Zweiteiliger Dichteinsatz lang / two-piece sealing insert long

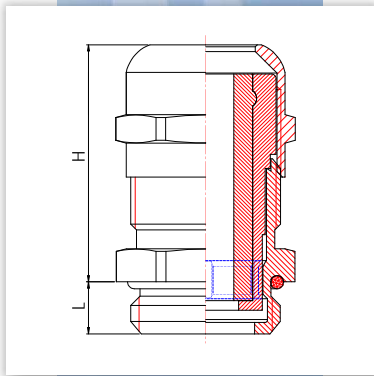

| kurzes Anschlussgewinde / short connection thread |    |      |    |    |     |    |            |
|---|----|------|----|----|-----|----|------------|
| M 16 x 1,5  | 5  | - 10 | 17 | 24 | 5,5 | 50 | 305.1600.0 |
| M 20 x 1,5  | 8  | - 14 | 22 | 26 | 6   | 50 | 305.2000.0 |
| M 25 x 1,5  | 12 | - 19 | 30 | 31 | 7   | 25 | 305.2500.0 |
| M 32 x 1,5  | 15 | - 22 | 34 | 32 | 8   | 25 | 305.3200.0 |
| M 40 x 1,5  | 22 | - 28 | 44 | 39 | 8   | 10 | 305.4000.0 |
| M 50 x 1,5  | 28 | - 36 | 54 | 47 | 9   | 5  | 305.5000.0 |
| M 63 x 1,5  | 34 | - 49 | 66 | 48 | 10  | 5  | 305.6300.0 |



|         |    |      |    |    |     |    |            |
|---------|----|------|----|----|-----|----|------------|
| Pg 9    | 5  | - 10 | 17 | 22 | 6   | 50 | 300.0900.0 |
| Pg 11   | 5  | - 10 | 20 | 24 | 6   | 50 | 300.1100.0 |
| Pg 13,5 | 8  | - 14 | 22 | 25 | 6,5 | 50 | 300.1300.0 |
| Pg 16   | 10 | - 15 | 24 | 27 | 6,5 | 50 | 300.1600.0 |
| Pg 21   | 12 | - 19 | 30 | 28 | 7   | 25 | 300.2100.0 |
| Pg 29   | 22 | - 28 | 40 | 36 | 8   | 25 | 300.2900.0 |
| Pg 36   | 28 | - 36 | 50 | 45 | 9   | 10 | 300.3600.0 |
| Pg 48   | 34 | - 49 | 66 | 46 | 10  | 5  | 300.4800.0 |

| langes Anschlussgewinde / long connection thread |    |      |    |    |    |    |            |
|--|----|------|----|----|----|----|------------|
| M 16 x 1,5                                       | 5  | - 10 | 17 | 24 | 12 | 50 | 306.1600.0 |
| M 20 x 1,5                                       | 8  | - 14 | 22 | 26 | 12 | 50 | 306.2000.0 |
| M 25 x 1,5                                       | 12 | - 19 | 30 | 31 | 15 | 25 | 306.2500.0 |
| M 32 x 1,5                                       | 15 | - 22 | 34 | 32 | 15 | 25 | 306.3200.0 |
| M 40 x 1,5                                       | 22 | - 28 | 44 | 39 | 15 | 10 | 306.4000.0 |
| M 50 x 1,5                                       | 28 | - 36 | 54 | 47 | 15 | 5  | 306.5000.0 |
| M 63 x 1,5                                       | 34 | - 49 | 66 | 48 | 15 | 5  | 306.6300.0 |

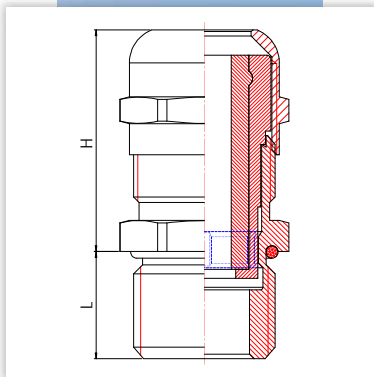

**i** Verbesserte Zugentlastung durch Profil-Dichteinsatz

**i** Improved strain relief with profile sealing insert

|                   |  |  |   |   |  |                            |
|-------------------|--|--|---|---|--|----------------------------|
| Gewinde<br>thread |  |  | H | L |  | Bestell-Nr.<br>ref.-number |
|-------------------|--|--|---|---|--|----------------------------|

### Einteiliger Dichteinsatz lang / one-piece sealing insert long

#### kurzes Anschlussgewinde / short connection thread

|  |    |   |     |    |    |     |     |            |
|--|----|---|-----|----|----|-----|-----|------------|
| M 12 x 1,5   | 5  | – | 7   | 14 | 22 | 5   | 100 | 305.1200.1 |
| M 16 x 1,5   | 4  | – | 6,5 | 17 | 24 | 5,5 | 50  | 305.1600.3 |
| M 16 x 1,5   | 5  | – | 7,5 | 17 | 24 | 5,5 | 50  | 305.1600.2 |
| M 16 x 1,5   | 8  | – | 10  | 17 | 24 | 5,5 | 50  | 305.1600.1 |
| M 20 x 1,5   | 11 | – | 14  | 22 | 26 | 6   | 50  | 305.2000.1 |
| M 25 x 1,5   | 15 | – | 19  | 30 | 31 | 7   | 25  | 305.2500.1 |
| M 32 x 1,5   | 19 | – | 22  | 34 | 32 | 8   | 25  | 305.3200.1 |
| M 40 x 1,5   | 25 | – | 28  | 44 | 39 | 8   | 10  | 305.4000.1 |
| M 50 x 1,5   | 32 | – | 36  | 54 | 47 | 9   | 5   | 305.5000.1 |
| M 63 x 1,5   | 25 | – | 36  | 66 | 48 | 10  | 5   | 305.6300.2 |
| M 63 x 1,5   | 43 | – | 49  | 66 | 48 | 10  | 5   | 305.6300.1 |
| <b>kurzes Anschlussgewinde / short connection thread</b> |    |   |     |    |    |     |     |            |
| Pg 7   | 5  | – | 7   | 14 | 21 | 5   | 100 | 300.0700.1 |
| Pg 9   | 4  | – | 6,5 | 17 | 22 | 6   | 50  | 300.0900.3 |
| Pg 9   | 5  | – | 7,5 | 17 | 22 | 6   | 50  | 300.0900.2 |
| Pg 9   | 8  | – | 10  | 17 | 22 | 6   | 50  | 300.0900.1 |
| Pg 11  | 4  | – | 6,5 | 20 | 24 | 6   | 50  | 300.1100.2 |
| Pg 11  | 5  | – | 7,5 | 20 | 24 | 6   | 50  | 300.1100.3 |
| Pg 11  | 8  | – | 10  | 20 | 24 | 6   | 50  | 300.1100.1 |
| Pg 13,5  | 11 | – | 14  | 22 | 25 | 6,5 | 50  | 300.1300.1 |
| Pg 16  | 13 | – | 15  | 24 | 27 | 6,5 | 50  | 300.1600.1 |
| Pg 21  | 15 | – | 19  | 30 | 28 | 7   | 25  | 300.2100.1 |
| Pg 29  | 25 | – | 28  | 40 | 36 | 8   | 25  | 300.2900.1 |
| Pg 36  | 32 | – | 36  | 50 | 45 | 9   | 10  | 300.3600.1 |
| Pg 48  | 25 | – | 36  | 66 | 46 | 10  | 5   | 300.4800.2 |
| Pg 48  | 43 | – | 49  | 66 | 46 | 10  | 5   | 300.4800.1 |

#### langes Anschlussgewinde / long connection thread

|            |    |   |     |    |    |    |     |            |
|------------|----|---|-----|----|----|----|-----|------------|
| M 12 x 1,5 | 5  | – | 7   | 14 | 22 | 12 | 100 | 306.1200.1 |
| M 16 x 1,5 | 4  | – | 6,5 | 17 | 24 | 12 | 50  | 306.1600.3 |
| M 16 x 1,5 | 5  | – | 7,5 | 17 | 24 | 12 | 50  | 306.1600.2 |
| M 16 x 1,5 | 8  | – | 10  | 17 | 24 | 12 | 50  | 306.1600.1 |
| M 20 x 1,5 | 11 | – | 14  | 22 | 26 | 12 | 50  | 306.2000.1 |
| M 25 x 1,5 | 15 | – | 19  | 30 | 31 | 15 | 25  | 306.2500.1 |
| M 32 x 1,5 | 19 | – | 22  | 34 | 32 | 15 | 25  | 306.3200.1 |
| M 40 x 1,5 | 25 | – | 28  | 44 | 39 | 15 | 10  | 306.4000.1 |
| M 50 x 1,5 | 32 | – | 36  | 54 | 47 | 15 | 5   | 306.5000.1 |
| M 63 x 1,5 | 25 | – | 36  | 66 | 48 | 15 | 5   | 306.6300.2 |
| M 63 x 1,5 | 43 | – | 49  | 66 | 48 | 15 | 5   | 306.6300.1 |

- Auch mit Dichtkappe oder Blindscheibe als Staubschutz lieferbar – Seite 86/87



- Available as well with sealing cap or blank disc as dust-protection – page 86/87

