

# TEC 50

## High performance bagging



### DESCRIPTION

The **TEC 50** is designed for the automatic bagging of various types of solid products, in large series, with a high level of productivity. It is available in the following versions :

- **TEC 50 L** : for large volume bags, suitable for bulk filling.
- **TEC 55** : for high speed work.

These models are available in all stainless steel to meet the requirements of the food industry and are available in vertical, inclined or horizontal versions.

### INNOVATIVE

Human/machine touch interface oriented **Industry 4.0** to :

- *Maintain*
- *Visualize / Report*
- *Exploit / Inform*



MADE IN FRANCE

### FUNCTIONING

The **TEC 50** operates from a voltage-regulated flat film reel.

- 1** The film is conformed around a tube, called "conformer"
- 2** The parts are introduced into the conformator in manual or automatic mode
- 3** The longitudinal sealing unit makes a back seal in the middle of the bag
- 4** The cross-sealing unit seals the bottom and top of the bags simultaneously and separates them

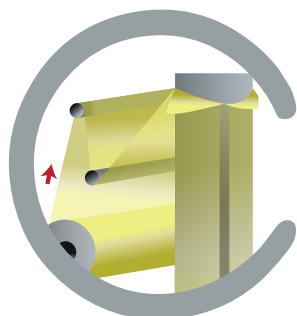

The conformer forms the bag in its width

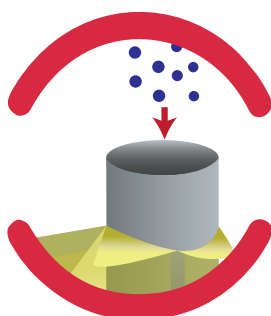

This principle avoids any risk of loss of parts

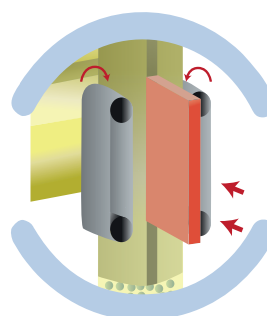

Formation of the bag in its length

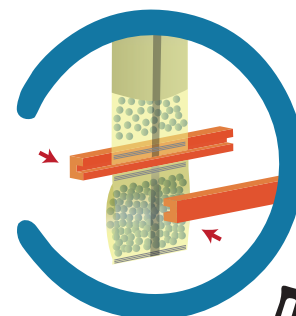

The addition of a picking system allows the realization of bags with flat bottom



## PERFORMANCES

- ⇒ Programmable controller
- ⇒ Up to 5 "BRUSHLESS" motors
- ⇒ Touch screen and color man-machine interface
- ⇒ Production counter
- ⇒ Two welding technologies

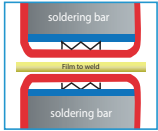

**Impulse welding**  
Jaws equipped with welding wires

**Thermal welding**  
Grooved and heated jaws

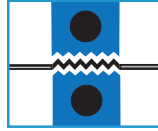

- ⇒ Cylindrical, oval, square or rectangular conformer
- ⇒ Motorized quick release coil holder
- ⇒ In its high speed version, the film is pulled by a suction belt

## OPTIONS & ACCESSORIES

- ⇒ Identification by direct printing on thermal transfer film and/or application of labels
- ⇒ Heavy parts receiving flap
- ⇒ Horizontal and inclined version to protect fragile products
- ⇒ Cell for pre-printed film
- ⇒ Bag vibrator for uniformity of parts
- ⇒ Flat bottom bag : gussets or marked corners

### Possible synchronization with other devices :

- Linear or multihead weigher
- Volumetric dosing unit with cups or screw
- Checkweigher
- Metal detector



## PACKING MATERIALS

- 🌱 Biodegradable Oxo film or Biodegradable type PLA
- 🌱 Paper
- ⇒ PE film
- ⇒ Heat-sealable complex such as PP
- ⇒ Neutral or pre-printed film

### GREEN SOLUTIONS



Our machines allow the passage of 100% ecological, biosourced, recyclable and biodegradable plastic or paper sleeves

## BAG SHAPES

XXL size  
Up to 300 L

### CUSHION BAG SYMMETRIC



### OPTIONAL

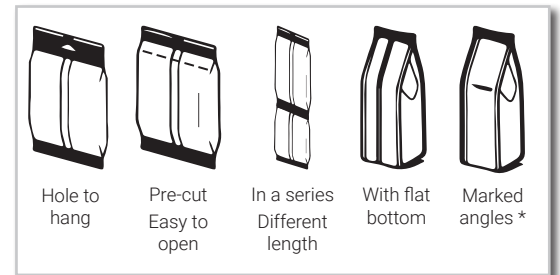

\* with possibility of asymmetric longitudinal welding

## TECHNICAL CHARACTERISTICS

		TEC 50	TEC 50 L	TEC 55
<b>Cadence</b> <small>(Depending on film type, quality, thickness ...)</small>		30 bags/min	20 bags/min	80 bags/min
<b>Bag weight</b>		Up to 600gr in PE and 1000gr in PP	Up to 1000 gr	Up to 1000 gr <small>(Higher weight with receiving flap)</small>
<b>Bag size</b>	Width	50 to 390 mm	100 to 800 mm	60 to 260 mm
	Length	60 to 300 mm	250 to 1000 mm	60 to 300 mm
	Head opening	150 or 250 mm	350 mm	150 mm
<b>Coil size</b>		Diameter : 320 mm		
<b>Packing materials</b>		PE or thermal welding complex	PE	Thermal welding complex
		Thickness : 50 to 120µ in PE 10 to 50µ in PP	Thickness : 50 to 120µ in PE	Thickness : 10 to 50µ in PP
<b>Power supply</b>		220 V single-phase 50hz / 6 bars		
<b>Machine weight</b>		400 kg	1000 kg	650 kg

