

Bluetooth Speaker with wireless charger E201

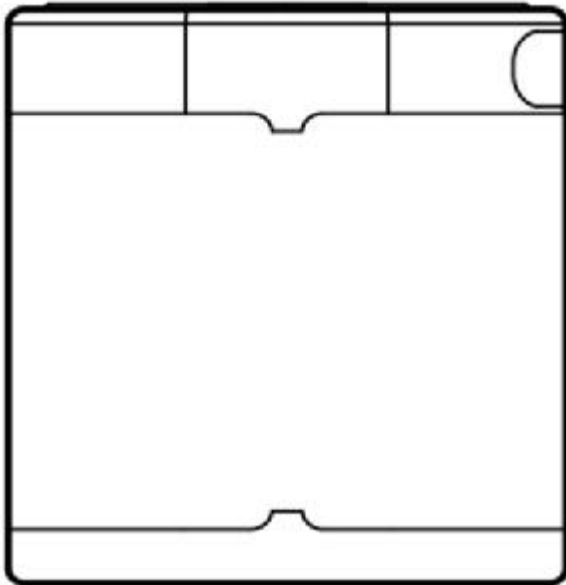

Instruction Manual

Package:

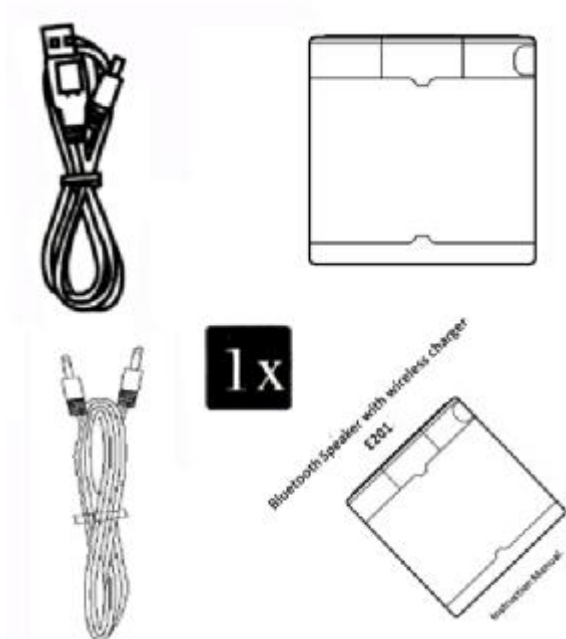

1pc E201 Speaker, 1pc AUX Cable, 1pc Micro USB Charging Cable and 1pc User Manual

IMPORTANT: IF THE MISIK E201 SPEAKER IS NOT CONNECTED TO THE AC POWER WHILE YOU ARE USING THE WIRELESS CHARGER IT WILL ONLY CHARGE YOUR SMART PHONE FROM 0% UP TO 60% - 70%; IF YOU WANT TO FULLY CHARGE YOUR SMART PHONE CONNECT THE SPEAKER E201 TO THE AC POWER WHILE USING THE WIRELESS CHARGER.

Buttons functions

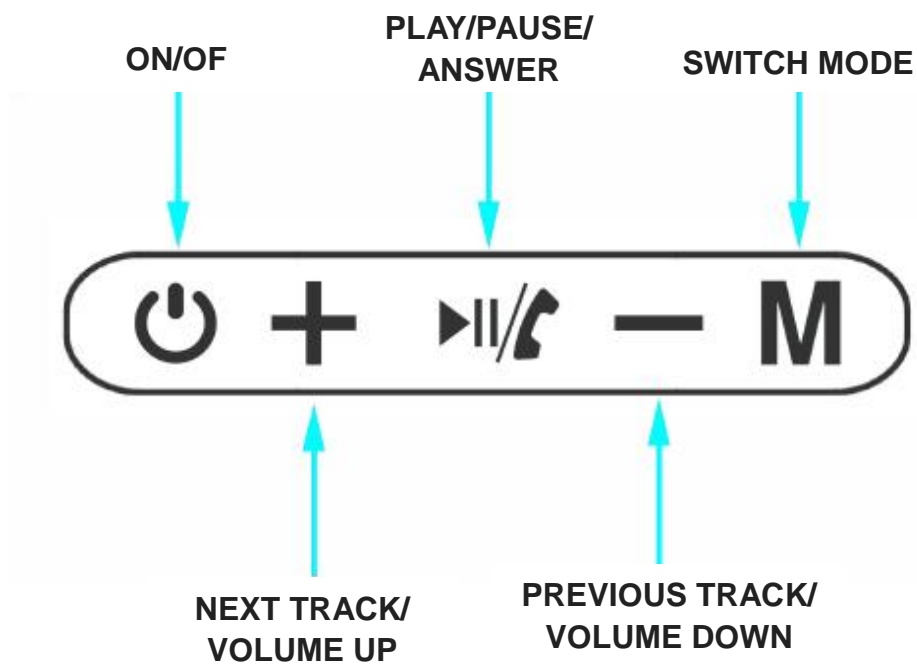

Power On/Off

Press the power button for 3 seconds to power on or power off.

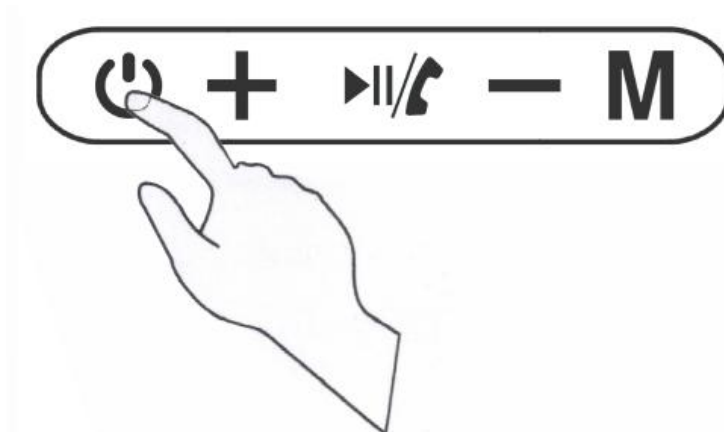

Bluetooth mode

Press 'M' button switching to Bluetooth mode, it's ready to pair. Turn on the Bluetooth of your mobile phone or other device then click search, 'E201', will be shown on the display. Select 'E201' then it will pair automatically. There will be a prompt sound after connection succeed.

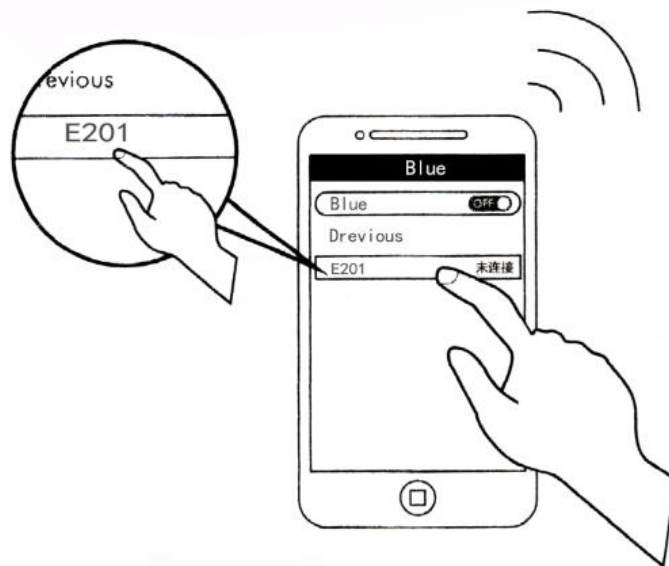

AUX Mode

Use the supplied Aux cable connect to your 3.5mm device, press 'M' button switching to Aux Mode.

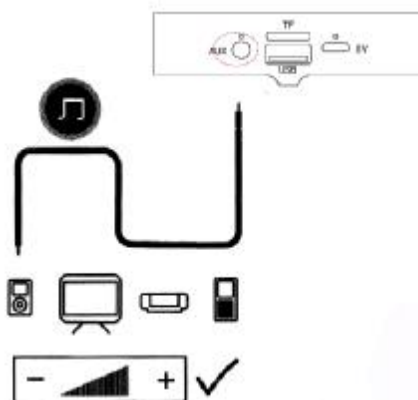

Music Mode (Played by USB)

Insert your USB disk into the unit, press 'M' switching Music mode, it will play the audio files in the USB automatically. (It supports maximum 32GB USB flash disk.)

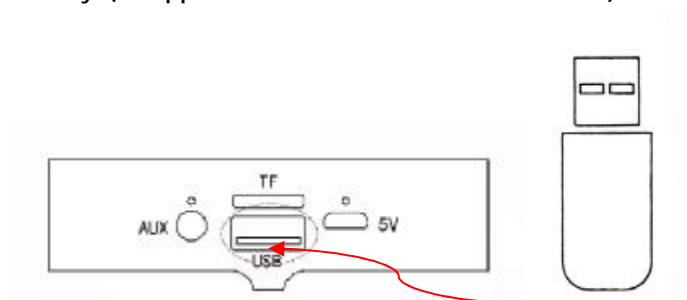

MICRO SD/TF Slot

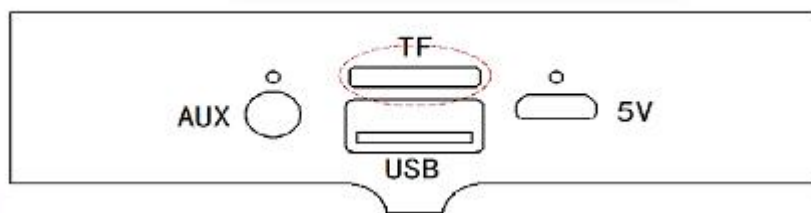

(Max 32GB)

Insert the Micro SD/TF card in the correct direction to the TF slot of speaker, there will be a prompt sound, and then play the audio files in the card. It supports maximum 32GB micro SD/TF card.

FM radio

Press the "M" button to switch to FM mode then Press '+' or '-' for Manual searching FM stations, press '▶||/◀' for auto-searching.

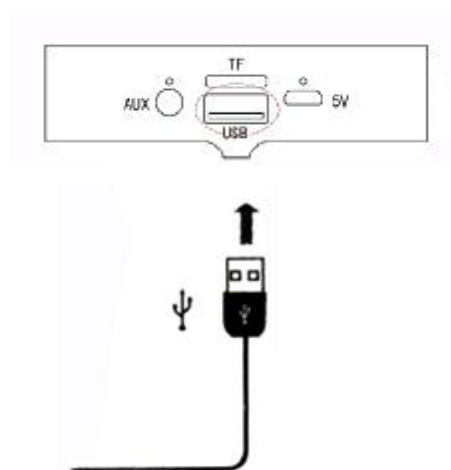

Use the USB charging cable as the FM antenna to enhance the radio signal.

Wireless Charge function

Put your phone which with wireless charge function on the top of E201. It will detect your phone and start to charge in 3 seconds. The blue charging indicators on both side of the speaker will be flashing.

If your phone can't be detected, press the '▶||/◀' button then it should be okay.

INSTRUCCIONES DE CARGA:

1. - PARA CARGAR SU TELEFONO INTELIGENTE, ES IMPORTANTE QUE SU BOCINA E201 ESTE ENCENDIDA.
2. - PARA CARGAR SU BOCINA E201 Y SU TELEFONO INTELIGENTE AL MISMO TIEMPO ES IMPORTANTE QUE SIGA LAS SIGUIENTES INSTRUCCIONES:
 - EN MODO APAGADO DE SU BOCINA E201 CONECTELA CON EL CABLE USB INCLUIDO A LA CORRIENTE ELECTRICA.
 - UNA VEZ CONECTADA ENCIENDA SU BOCINA E201
 - ESPERE UN MINUTO Y DESPUES COLOQUE SU TELEFONO INTELIGENTE EN EL CARGADOR INDUCTIVO PARA INICIAR SU CARGA