

FIX – gypsum adhesive

Product description:

FIX is a gypsum-based adhesive which is used for direct fixing of all types of plasterboards on walls made of concrete, aeroconcrete, bricks, etc., in premises with normal humidity.



Standard Classification::

In compliance with 14496:2017



Advantages:

- ✓ Excellent traction with the base
- ✓ High strength
- ✓ Fast gathering of strength
- ✓ Filling of small cavities

Application:

- ✓ Drywall linings without supporting structure
- ✓ Shaping of window and door openings
- ✓ Filling of cavities greater than 3 mm

Technical data

Time for work	~ 50 minutes
Consumption	~ 5 kg/m ²
Coverage	~ 5 m ² / 25 kg bag
Mixing ratio	~ 13 l water : 25 kg
Application temperature	5° - 30 ° C
Bond strength	0.23 MPa
Reaction to fire	A1
Expiry date	6 months

Instructions for use:

1. **Pre-treatment of substrate:** The substrate has to be clean, dust-free and oil-free! Coatings without bearing capacity must be removed. Strong or weak hygroscopic surfaces have to be primed in advance with a suitable primer to control absorbency and adhesion.
2. **Mixing:** Fill a very well cleaned, non-metallic container partially with water. Add to it the required amount of FIX (13 litres of water to a bag of 25 kg) slowly and gradually, so that the level of the gypsum mixture reaches 1-2 mm above water level. Let the material settle for 3-5 minutes. Then stir the mixture by hand using a trowel or mixer (400-800 rpm) until a homogeneous mixture without lumps is formed.

3. **Application:** The following three installation methods are used in relation to the unevenness of the substrate:

1) In case of unevenness up to 10 mm, a method of thin layers is used – FIX is applied in strips along the whole perimeter by using a toothed plastering trowel. Depending on the weight of the mounted board, one or two longitudinal strips of adhesive are added in the middle of the board.

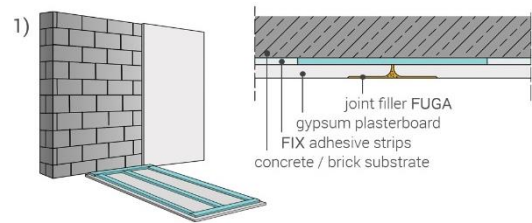

2) In case of unevenness between 10 and 20 mm, the adhesive is applied in the form of dabs with a diameter of 10 cm, in chess-board order at a distance of 30-40 cm in the horizontal and vertical line. Applying the adhesive dabs can be done on both the vertical base and the installation board depending on its size.

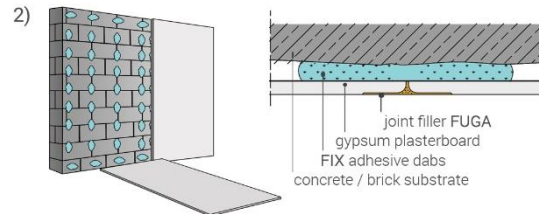

3) In case of unevenness over 20 mm, strips of plasterboard with a width of 100 mm are cut and fixed to the prepared base. FIX is applied to the leveled stripes of plasterboard by using a toothed plastering trowel, after which the plasterboards are fixed.

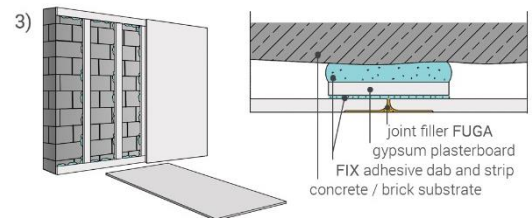

When the plasterboards are mounted, paddings with a thickness of around 10 mm have to be placed on the side of the floor, with the purpose of forming joint which absorbs the linear expansion of the boards.

Special notes:

- ✓ It is mandatory to use perfectly clean instruments without traces of rust. Otherwise, the characteristics of the products and its bonding time can be substantially changed.
- ✓ Avoid drastic temperature changes during ventilation of workrooms.

Packaging and Storage

- ✓ 25 kg paper bags. 40 bags in a pallet. Pallet weight 1000 kg.
- ✓ Store and transport it in a tightly sealed original packaging in closed, dry and ventilated areas.
- ✓ The product is suitable for use within 6 months after the production date.
- ✓ The properties of the product are guaranteed only when the product is stored and used in the right way.
- ✓ If the product becomes moist, hardened lumps will develop, which deteriorates its properties and shortens the bonding time.

Safety recommendations:

- ✓ Product not classified as hazardous.
- ✓ It is recommended to use safety gloves, mask and glasses when apply the product to prevent the risk of inhalation, irritation of the skin and eyes.

Technogips Pro reserves the right to change any of the specifications and technical data mentioned in the Technical Data Sheets at its sole discretion without prior notification. July 2019©